

820 N River St, Suite 103
Portland OR 97227

www.stueveoyce.com

p. 503.237.6404
f. 503.213.5509

SUITE 230
MAINLANDER
INVESTMENTS

Date: 01 MAY 2003

1,564 rsf
Floor Plan

A1

STUEVE & ROYCE ARCHITECTURE, INC. 2003
DO NOT REPRODUCE WITHOUT PERMISSION

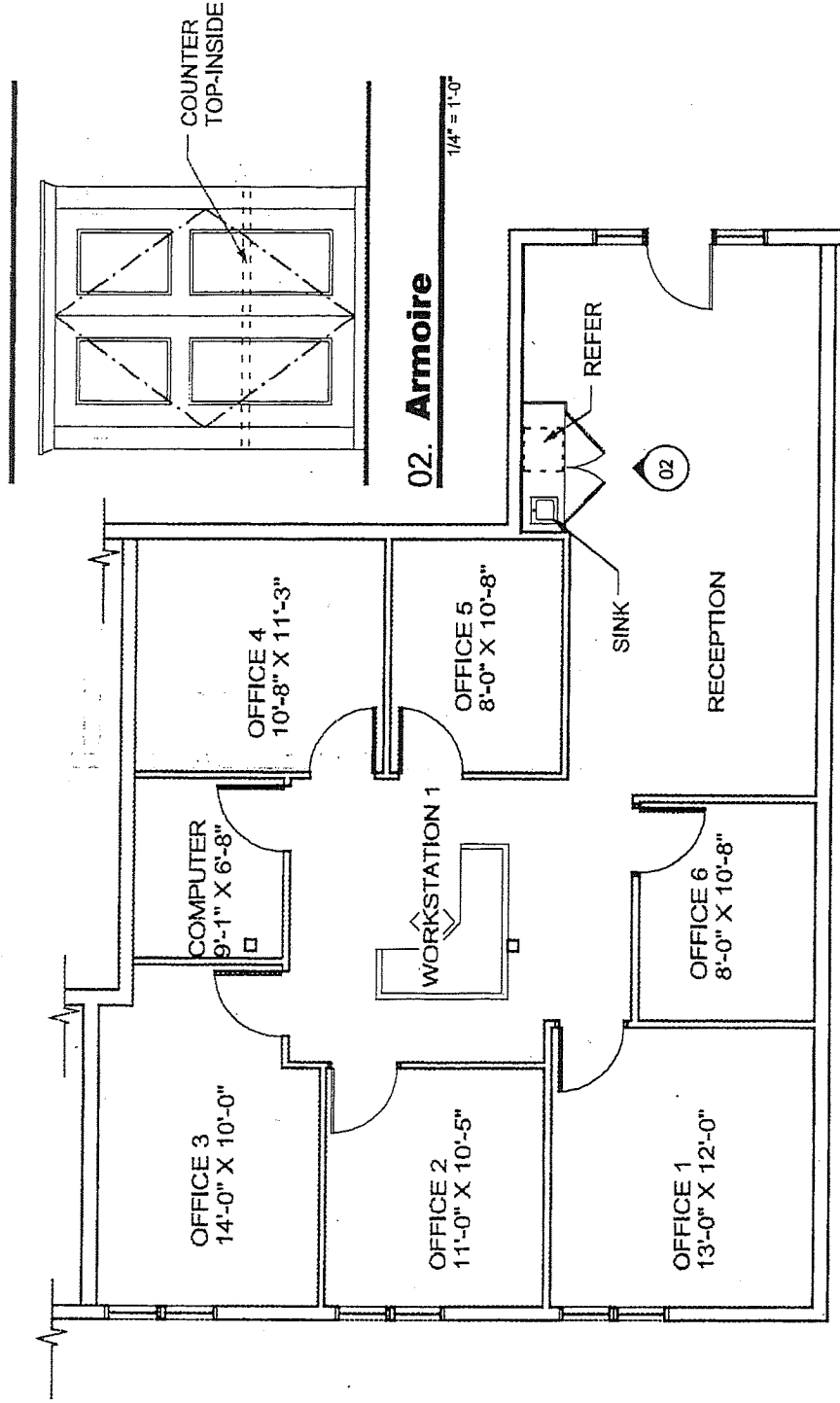

01. Floor Plan